

# FORENO.

TAPWARE MADE FOR NEW ZEALAND since 1969

## Floor Mounted Minimal Bath Mixer with Handshower BF95CH

Congratulations on your purchase of this high quality product from Foreno Tapware.  
Please read the following before installation and retain (along with your receipt) for future reference.

### TECHNICAL SPECIFICATIONS

#### Suitable for Mains Pressure only

Minimum Pressure = 150kPa

Maximum operating Pressure = 500kPa\* (As per NZ Building Code AS/NZ 3500.1)

Maximum operating Temperature = 65 deg. Celsius

For domestic use only.

### CONFIGURATION

Mains Pressure systems Install as supplied.

Unequal Low systems This product is not suitable for this type of water pressure.

Equal Low systems This product is not suitable for this type of water pressure.

### INSTALLATION

**\*FOR PRESSURES EXCEEDING 500kPa INSTALL A PRESSURE REDUCING VALVE. THOROUGHLY FLUSH ALL PIPES TO ELIMINATE ANY REMAINING DIRT AND RESIDUE, AND INSTALL INLINE FILTERS. FAILURE TO DO SO MAY VOID THE WARRANTY.**

See installation diagram on next page.

**Note for Plumber: Do not pressure test this mixer under static pressure.**

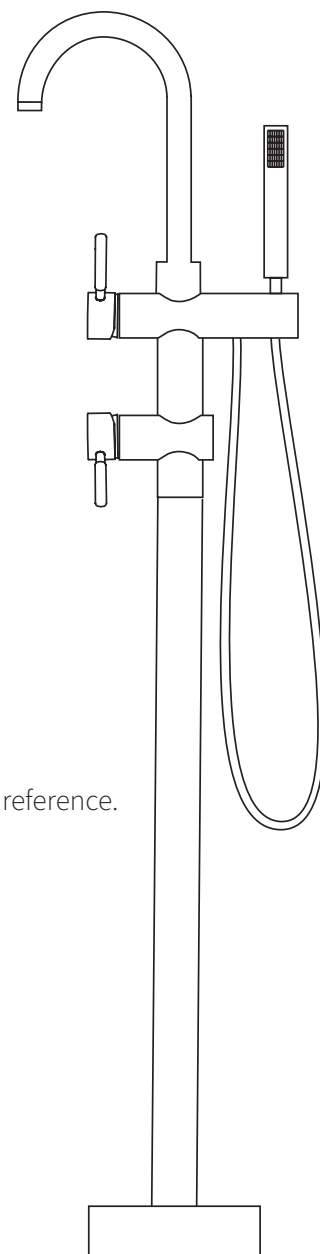

ATTACH PROOF OF PURCHASE HERE

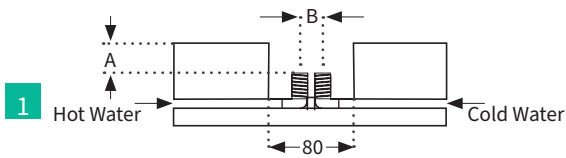

1 Prepare the input pipes as per diagram.  
The depth of A should be 30-40mm.  
Distance B should be kept to a minimum  $\approx$ 30-50mm.

1. Prepare the input pipes as per the diagram.
2. Put the decorative cover over the brass pipe.
3. Screw the pipe to the fixed seat.
4. Install the flexible hose and ensure the flexible hoses are hand tightened into place (DO NOT USE A SPANNER TO TIGHTEN as it can damage the O ring). The flexible hoses are to be fitted into the correct inlets for hot and cold water.
5. Fix the faucet body to the brass pipe.
6. Connect the other end of the flexible hose to the water supply pipe. Make sure they are fitted into the correct outlets for hot water and cold water.
7. Use the screws to fix the seat on the ground and put the decorative cover over the base.
8. Connect the hose to the base and the other end to the shower handpiece. Ensure the green Non-Return valve is inserted within the connection between the handshower hose and faucet body (8A). If flow isn't as expected check non return valve is installed in correct direction allowing full water flow.

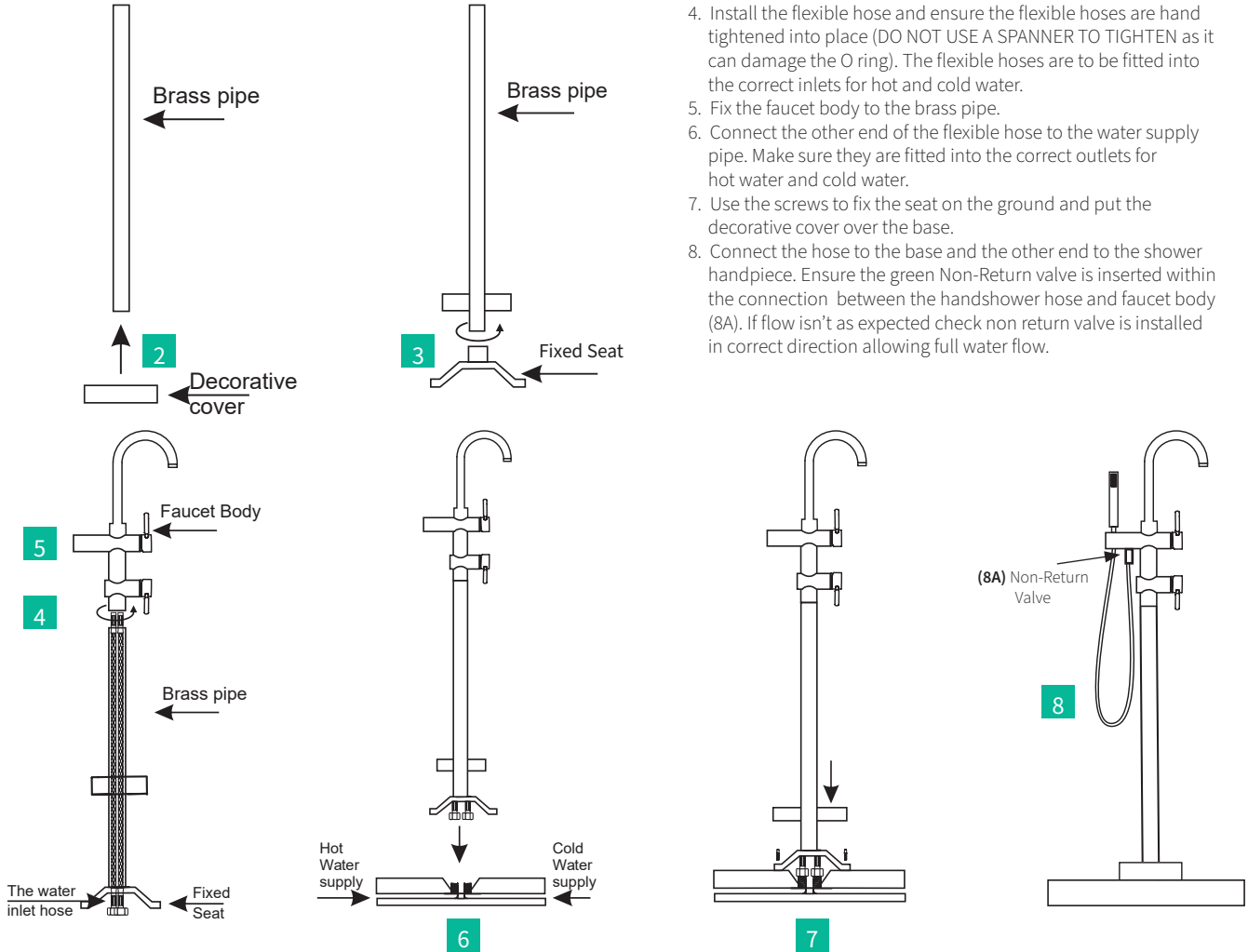

## WARRANTY

**PLEASE CALL US BEFORE REMOVING OR UNDERTAKING ANY REPAIR WORK.**

Please refer to our website for warranty information: [www.foreno.co.nz/warranty](http://www.foreno.co.nz/warranty)

In the unlikely event that this product fails during its warranty period, phone our Customer Service team immediately on 0508 FORENO (0508 367 366) – as unauthorised removal of the product may void the warranty.

## CARE AND MAINTENANCE

**SHOULD NOT BE CLEANED WITH ACIDIC, CAUSTIC/ALKALINE, ABRASIVE OR CITRIC CLEANERS.**

A soft, damp cloth is recommended for cleaning (Not a Micro fibre cloth). Mild soap solutions can also be used on occasion.

PROUD PARTNER AND SUPPORTER OF MASTER PLUMBERS, GASFITTERS AND DRAINLAYERS

