

FORENO.

FORPT65LF HEADWORKS REMOVAL AND REPLACEMENT

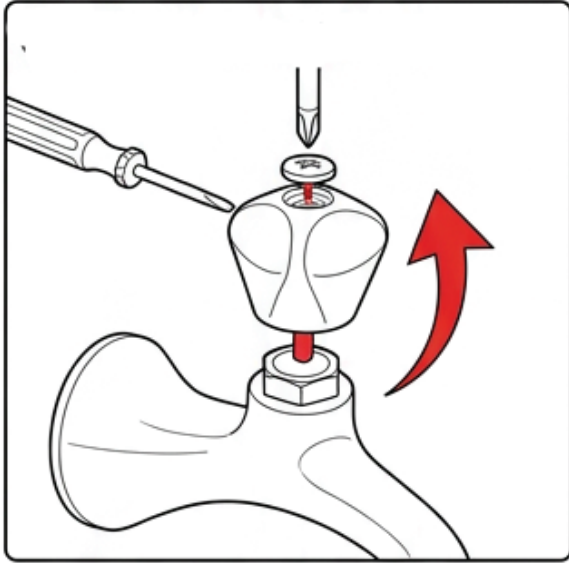

Turn off water at mains. Prise cap off handle top. Unscrew retaining screw. Pull handle upwards off splined shaft of headworks.

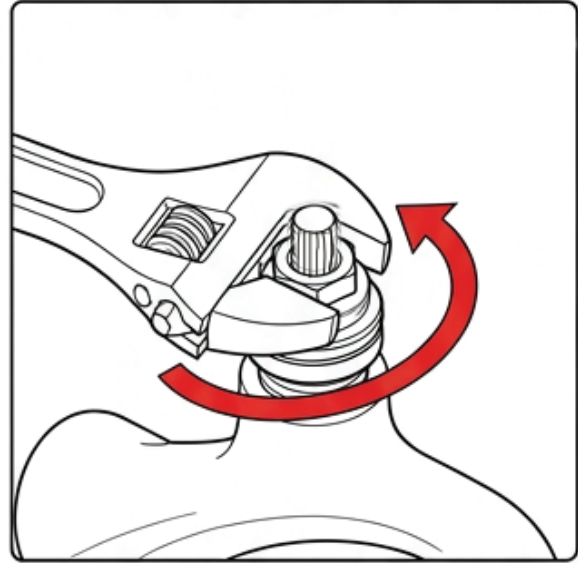

Using spanner or adjustable crescent, unscrew headworks turning anti-clockwise to remove.

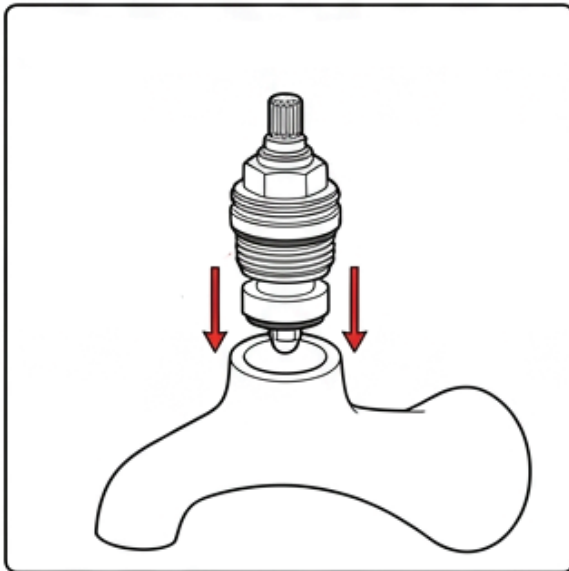

With headworks removed check internals of tap body and clean out any sediment, grit, or foreign material. Check washer seat inside tap body is smooth and free from damage or rough surface. A tap reseating tool can be used to smooth out internal surface if there are imperfections or rough spots that may cause a bad seal.

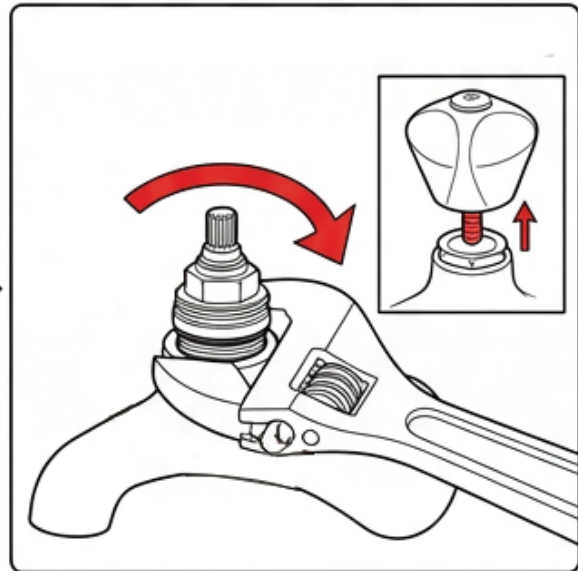

Fit headworks and tighten down firmly. Fit handle in place and check headworks for correct operation by opening and closing tap. Remove handle. Turn mains water supply back on and check for leaks. Refit handle and tighten screw firmly, refit indicator cap.

FORENO.

TAPWARE MADE FOR NEW ZEALAND since 1969