



FORENO.

NORTH Slide Shower

Chrome

NRT61RCH

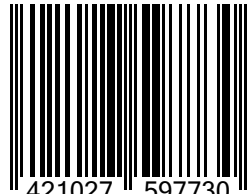

9 421027 597730

Congratulations on your purchase of this high quality product from Foreno Tapware. Please read the following before installation and retain (along with your receipt) for future reference.

TECHNICAL SPECIFICATIONS

Suitable for All Pressures

Minimum Pressure = 35kPa

Maximum operating Pressure = 500kPa*

Maximum operating Temperature = 65 deg. Celsius

For domestic use only.

CONFIGURATION

Mains Pressure systems Install the supplied flow restrictor between the shower hose and supply elbow with the black O-ring facing towards the direction of water flow (see image below).

Unequal Low systems Install as supplied.

Equal Low systems Install as supplied..

CONTENTS

- Rail with adjuster/holder
- Wall brackets and covers
- Fixing kit
- 1.5m supply hose
- Supply elbow
- Shower handpiece
- 8L/min Flow regulator for Mains Pressure installation

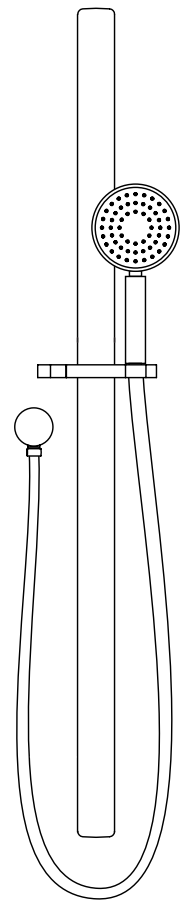
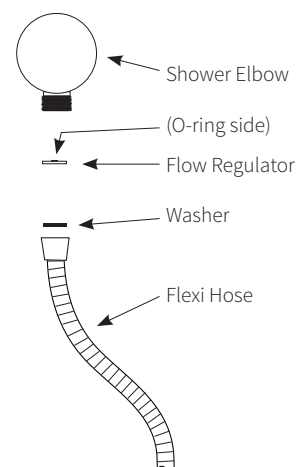
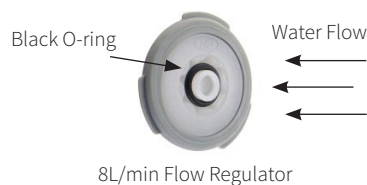

INSTALLATION

***FOR PRESSURES EXCEEDING 500kPa INSTALL A PRESSURE REDUCING VALVE. THOROUGHLY FLUSH ALL PIPES TO ELIMINATE ANY REMAINING DIRT AND RESIDUE, AND INSTALL INLINE FILTERS. FAILURE TO DO SO MAY VOID THE WARRANTY.**

See steps on the next page, then attach the supply elbow to the supply connection on the wall.

If installing on Mains pressure systems - please fit the flow regulator for optimal flow.

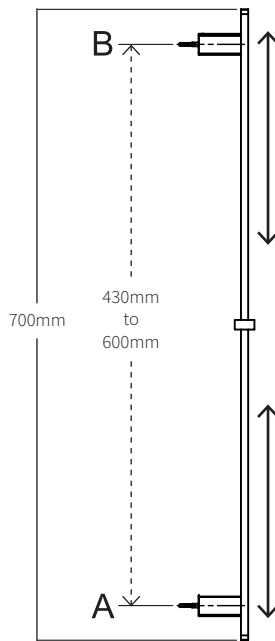
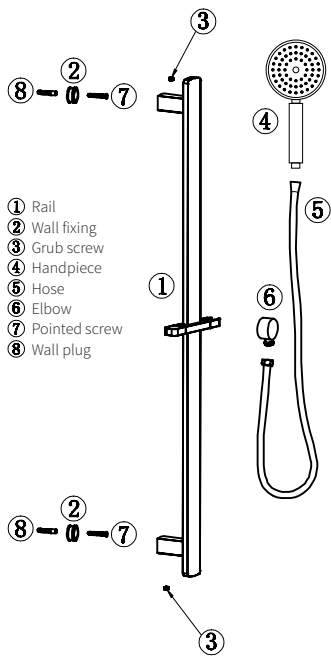

ATTACH PROOF OF PURCHASE HERE

1. Measure and mark hole positions (at points A and B) with a pencil at the required distance (max. 600mm apart).
2. Drill two mounting holes where you have marked.
3. Fit the wall fixing parts into the drilled holes.
4. Push the rail bracket onto the wall fixings, then tighten the grub screws.
5. Fix the elbow to the wall.
6. Attach hose to elbow and handpiece then insert shower handpiece into holder.

Bottom wall bracket can be adjusted to achieve desired height.

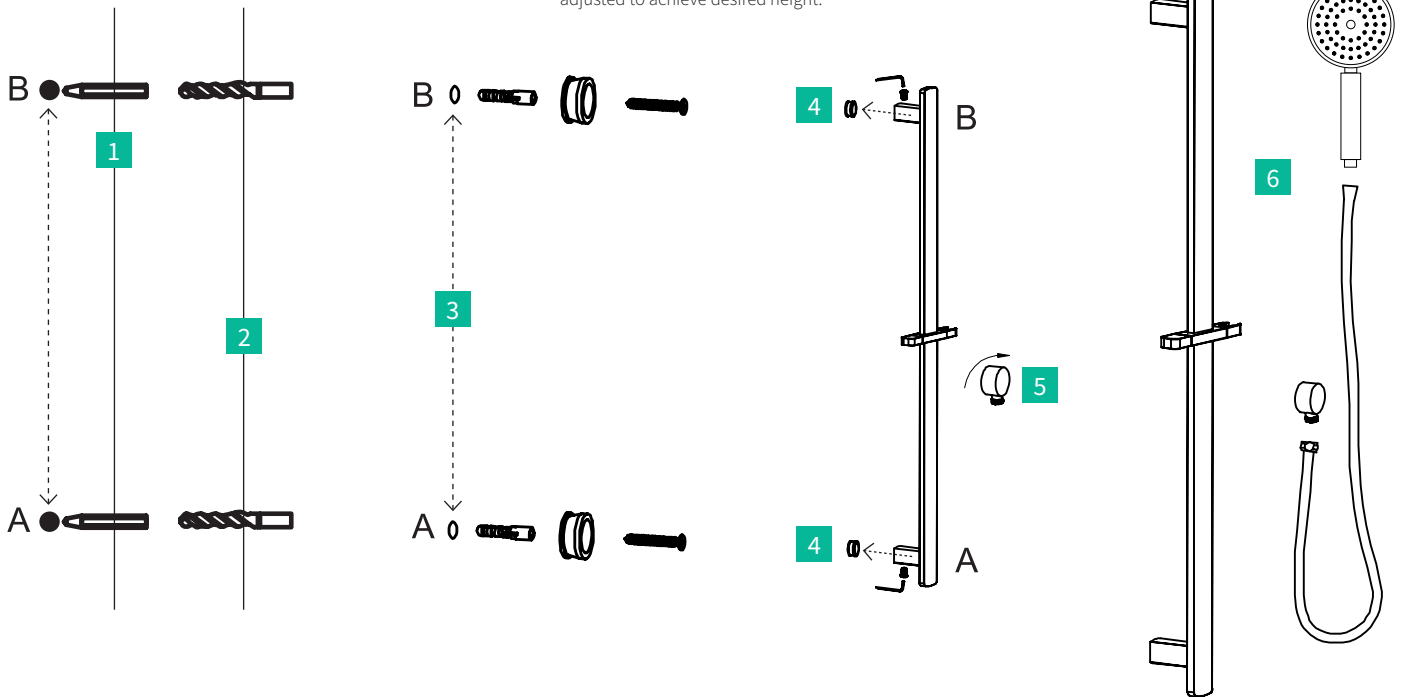

WARRANTY

PLEASE CALL US BEFORE REMOVING TAPWARE OR UNDERTAKING ANY REPAIR WORK.

Please refer to our website for warranty information: www.foreno.co.nz/warranty

In the unlikely event that this product fails during its warranty period, phone our Customer Service team immediately on 0508 FORENO (0508 367 366) – as unauthorised removal of the product may void the warranty.

CARE AND MAINTENANCE

SHOULD NOT BE CLEANED WITH ASTRINGENT, ABRASIVE OR CITRIC CLEANERS.

A soft, damp cloth is recommended for cleaning (Not a Micro fibre cloth). Mild soap solutions can also be used on occasion.