

FORENO.

TAPWARE MADE FOR NEW ZEALAND since 1969

TRADELINE Sink Faucet TL01LF

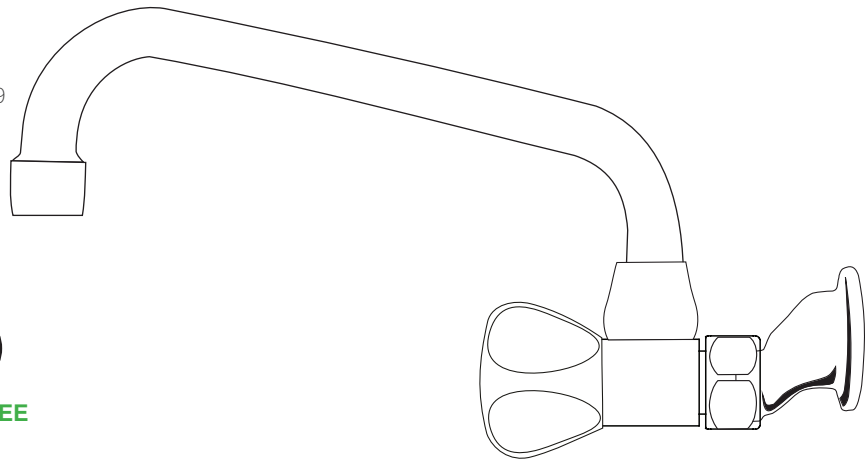

Congratulations on your purchase of this high quality product from Foreno Tapware.
Please read the following before installation and retain (along with your receipt) for future reference.

TECHNICAL SPECIFICATIONS

Suitable for All Pressures

Minimum Pressure = 17kPa

Maximum operating Pressure = 500kPa*

(As per NZ Building Code AS/NZ 3500.1)

Maximum operating Temperature = 65 deg. Celsius

For domestic use only.

CONFIGURATION

Mains Pressure systems Remove the aerator insert from the housing and change to the mains pressure insert supplied.

See diagram.

Unequal Low Systems Install as supplied.

Equal Low systems Install as supplied.

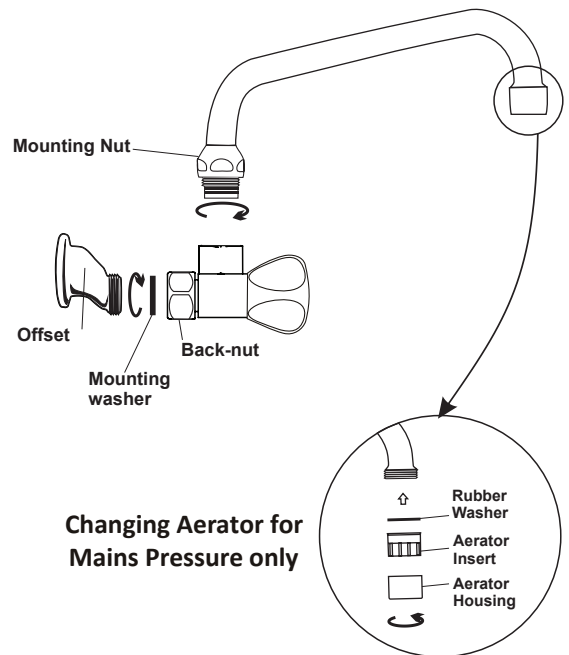

INSTALLATION

***FOR PRESSURES EXCEEDING 500kPa INSTALL A PRESSURE REDUCING VALVE. THOROUGHLY FLUSH ALL PIPES TO ELIMINATE ANY REMAINING DIRT AND RESIDUE, AND INSTALL INLINE FILTERS. FAILURE TO DO SO MAY VOID THE WARRANTY.**

- Fit offsets and body to wall mounted wing backs and adjust width to match the faucet body back-nuts. NB: It is essential to apply either Teflon sealing tape or graphite & hemp around the screwed tube prior to installation.
- Fit mounting washers to the faucet body back-nuts and hand-tighten back-nuts on to offsets. Do not over-tighten, only a quarter-turn with a wrench is required. Cover nuts with cloth to avoid scratching. NB: No thread tape is required on the external offset thread within the coupling.

ATTACH PROOF OF PURCHASE HERE

- Fit the centre spout.
- Hand-tighten the spout coupling nut on to the faucet body outlet thread. **Hand Tighten only, DO NOT OVER TIGHTEN.**
- Turn on water supply. Check for leaks. If there is any water seepage from the spout nut, it can be tightened a further quarter turn with adjustable spanner, covering the chrome surface with a cloth to prevent scratching.

WARRANTY

PLEASE CALL US BEFORE REMOVING TAPWARE OR UNDERTAKING ANY REPAIR WORK.

Please refer to our website for warranty information: www.foreno.co.nz/warranty

In the unlikely event that this product fails during its warranty period, phone our Customer Service team immediately on 0508 FORENO (0508 367 366) – as unauthorised removal of the product may void the warranty.

CARE AND MAINTENANCE

SHOULD NOT BE CLEANED WITH ACIDIC, CAUSTIC/ALKALINE, ABRASIVE OR CITRIC CLEANERS.

A soft, damp cloth is recommended for cleaning (Not a Micro fibre cloth). Mild soap solutions can also be used on occasion.

See FORENO. website for full care instructions: www.foreno.co.nz/tapware-care-instructions/

PROUD PARTNER AND SUPPORTER OF MASTER PLUMBERS, GASFITTERS AND DRAINLAYERS



Master Plumbers
Representing Excellence



Master Gasfitters
Representing Excellence



Master Drainlayers
Representing Excellence